



**Dewdney Avenue Revitalization  
RWBID Information Session #2**  
March 2023



# Land Acknowledgement

We acknowledge we are on the traditional lands of the Treaty 4 Territory, a Treaty signed with 35 First Nations across Southern Saskatchewan and parts of Alberta and Manitoba, and the original lands of the Cree, Saulteaux, Dakota, Nakota, Lakota, and the homeland of the Métis.

We respect and honour Treaty 4 and strive to maintain the spirit of Reconciliation in the work that we do.

# AGENDA



**The Project**



**The Process**



**The Design**



**The Construction**

# Dewdney Avenue Revitalization

The **Dewdney Avenue Revitalization** project will transform Dewdney Avenue (from Albert St to Broad St) into a more aesthetically pleasing and vibrant corridor with improved pedestrian and vehicular traffic safety to meet the growing needs of the community.

--- Project Area

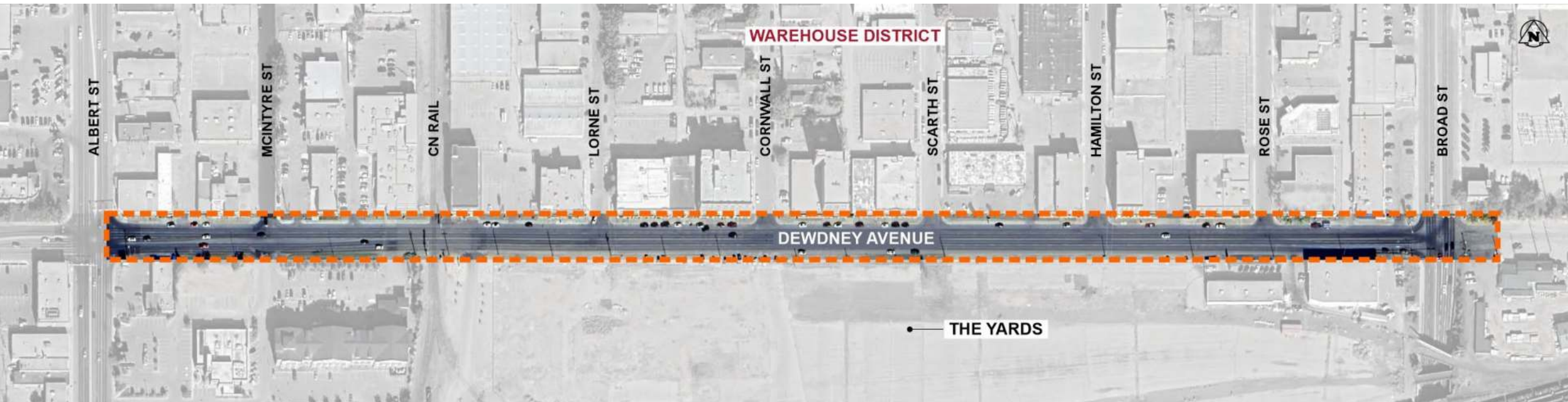

# Project Opportunities

- Replace **Aging** at-risk underground water and sewer infrastructure.
- **Transform** Dewdney Avenue to align with the ***Yards Neighbourhood Plan's*** vision of a pedestrian-orientated landscaped urban roadway with an enhanced public realm.
- Provide necessary capacity to support **Future Growth** and encourage economic investment within the Warehouse District.



# Project Process

Yards Neighbourhood Plan – Dewdney Ave Concept Developed and Approved by Council

(Nov 2014 – Jan 2020)



Preliminary Design of Dewdney Ave

(Nov 2021 – Oct 2022)



Detailed Design of Dewdney Ave

(Nov 2022 – Apr 2023)



Construction  
(2023 – 2024)

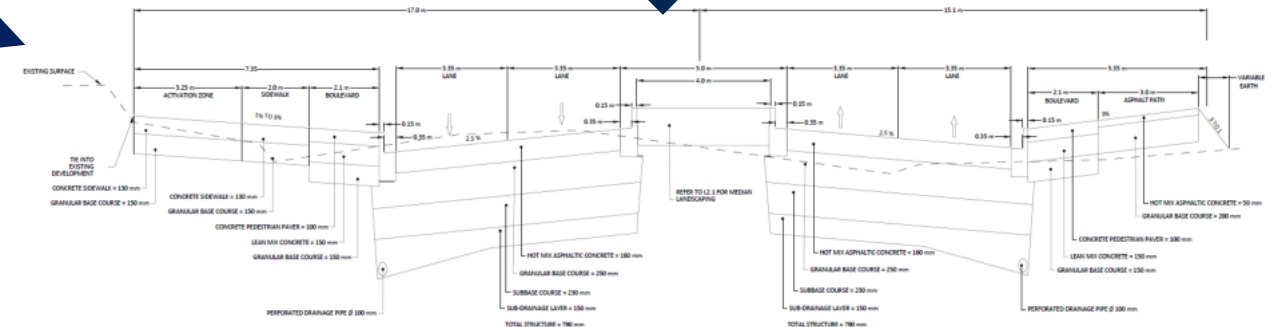
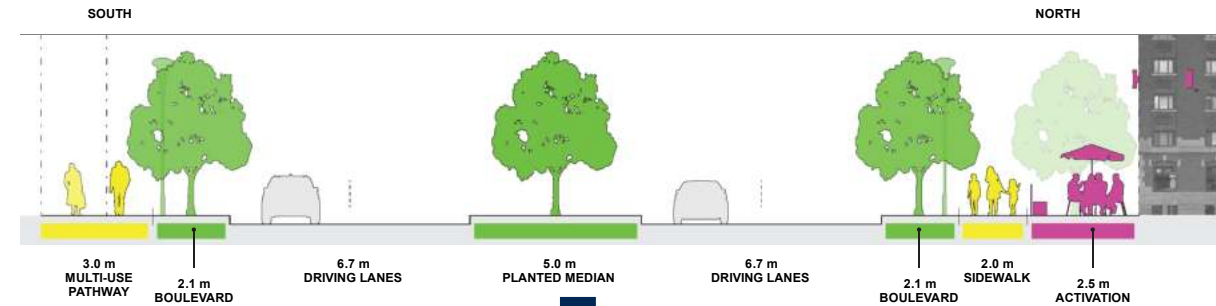
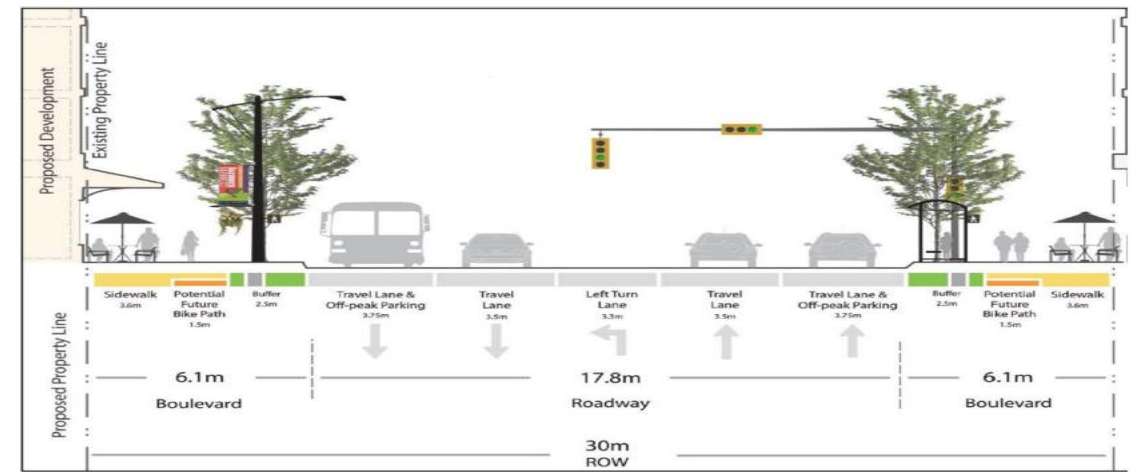

CITY OF REGINA | INFRASTRUCTURE

# Project Process – Engagement

## Conceptual Design (Yards Neighbourhood Plan)

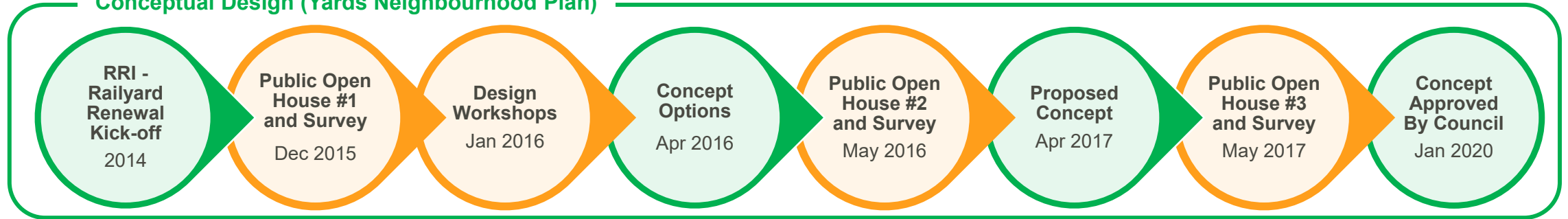

## Preliminary Design



## Detailed Design



## Construction



# Project Process – Engagement

Conceptual Design (Yards Neighbourhood Plan)



Preliminary Design



Detailed Design

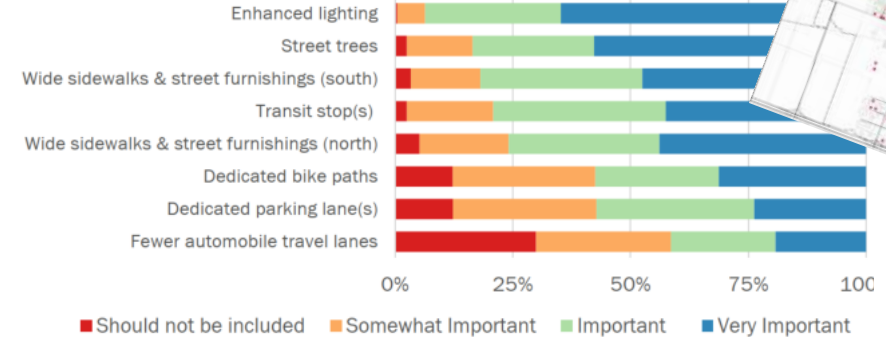

# Project Process

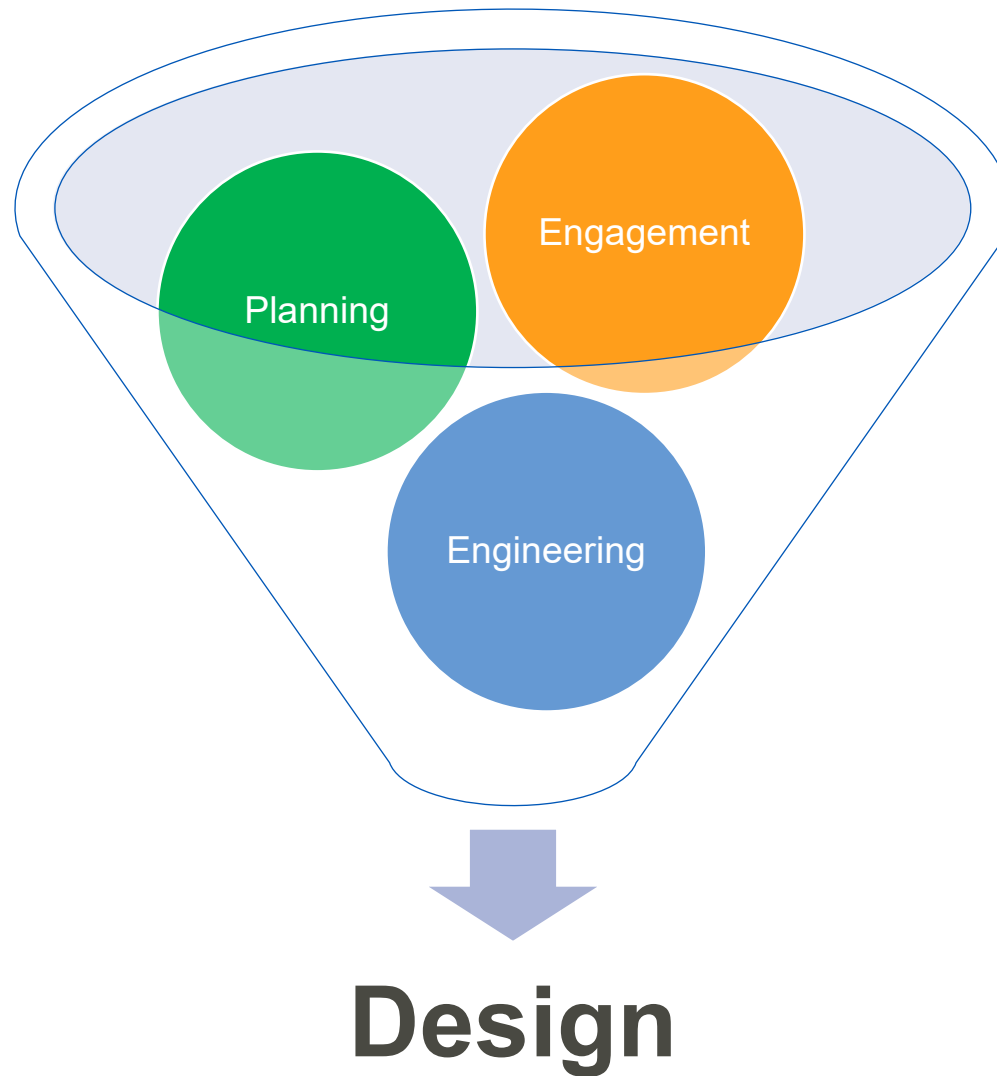

# Undergrounds Design



## Water

- Replace **800m** of 100+ year-old cast iron pipe with a new large diameter water supply main to address aging infrastructure.
- Replace **all** existing lead service connections and fire hydrants to meet current City standards.
- Install **two** new stubs to service the Yards and upsizing existing connections into the Regina Warehouse District to support future growth.



## Wastewater

- Replace **800m** of 100+ year-old clay tile pipe with new wastewater sewer main.
- Install **600m** of new large diameter wastewater storage to support future growth.



## Stormwater

- Install **1km** of new storm sewer pipe to collect and transfer stormwater.
- Replace **all** existing catch basins with high-capacity catch basins to meet current City standards.

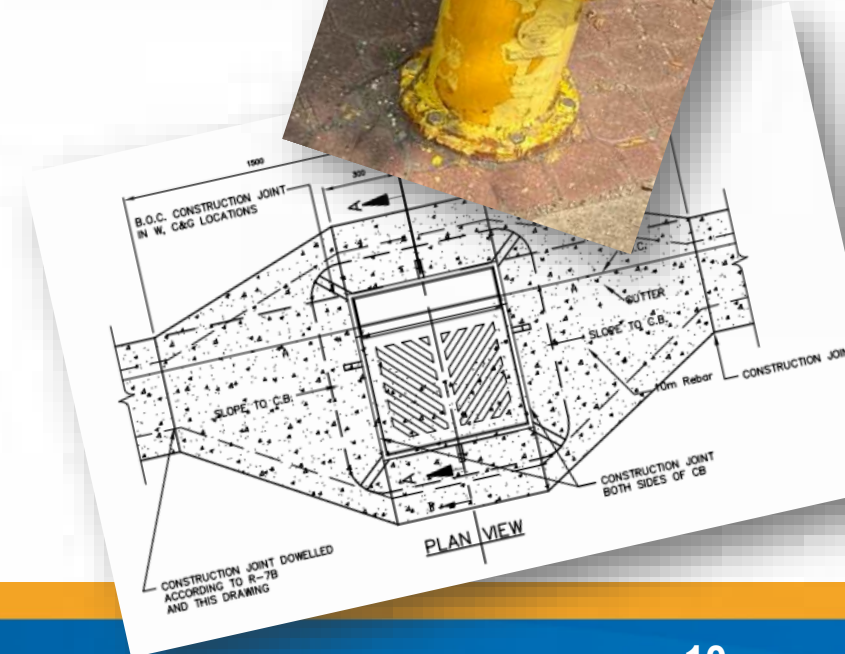

# Transportation Design – Plan

- Three zones with varying cross sections:
  - **Zone 1 (Albert to CNR):** Transition zone between Albert St and CNR intersection. 30m right-of-way.
  - **Zone 2: (CNR to Hamilton):** Focus on public realm improvements. 32m right-of-way.
  - **Zone 3: (Hamilton to Broad):** Transition zone between Hamilton and Broad St. 30m right-of-way.
- **New** traffic signals with left-turn bays provided into the Warehouse District and future Yards Neighbourhood.

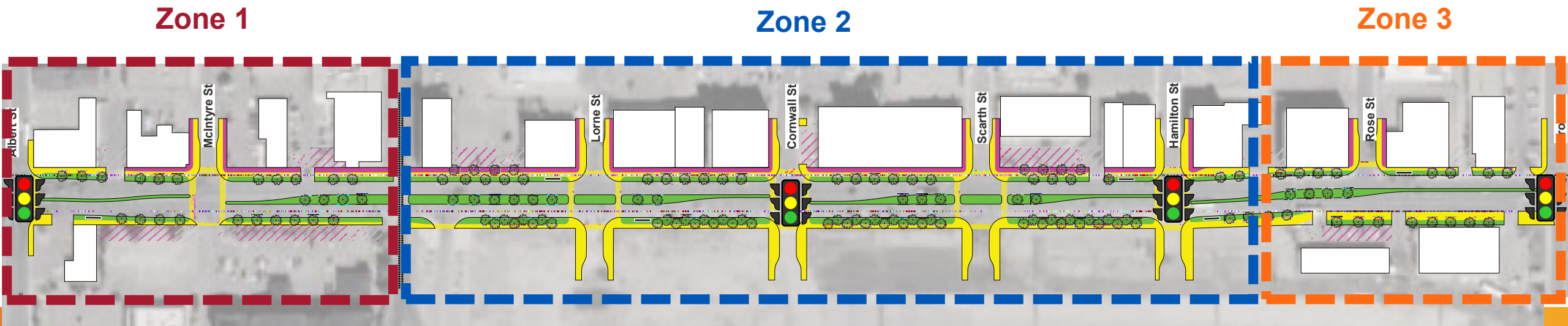

# Transportation Design – Zone 2: (CNR to Hamilton):

- 1 Travel Lanes** support movement of private vehicles and transit travelling through the area.
- 2 Parking Lanes (Off-Peak Hours)** support access to the businesses for those who will be staying in the area.
- 3 Boulevards** provide separation from traffic and space for trees, light fixtures, signs, transit shelters etc.
- 4 Wide Sidewalks** provides accessible space for unencumbered pedestrian travel.
- 5 Activation Area** provides space for accessibility ramps, outdoor cafes, sandwich boards, sidewalk sales, informal gathering spaces, seating, etc.
- 6 Multi-Use Pathway (Temporary)** provides active transportation connectivity for interim uses of the Yards.
- 7 Median** provides for storage for left-turn traffic, access control, landscaping, lighting, snow storage, pedestrian refuge, vehicle safety.

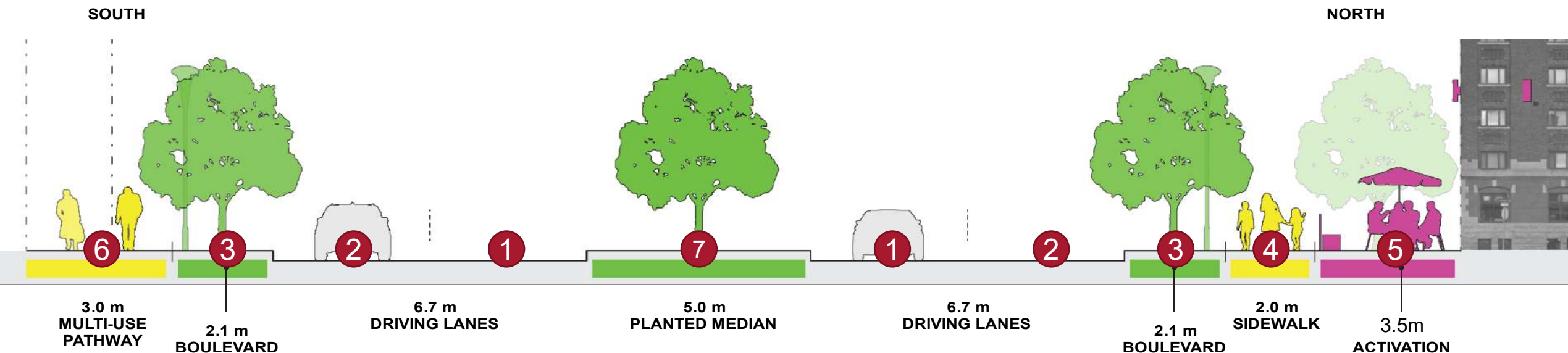

# Transportation Design – Zone 1 (Albert to CNR)

- 1 Narrower **Activation Area** due to the 30 m right-of-way.

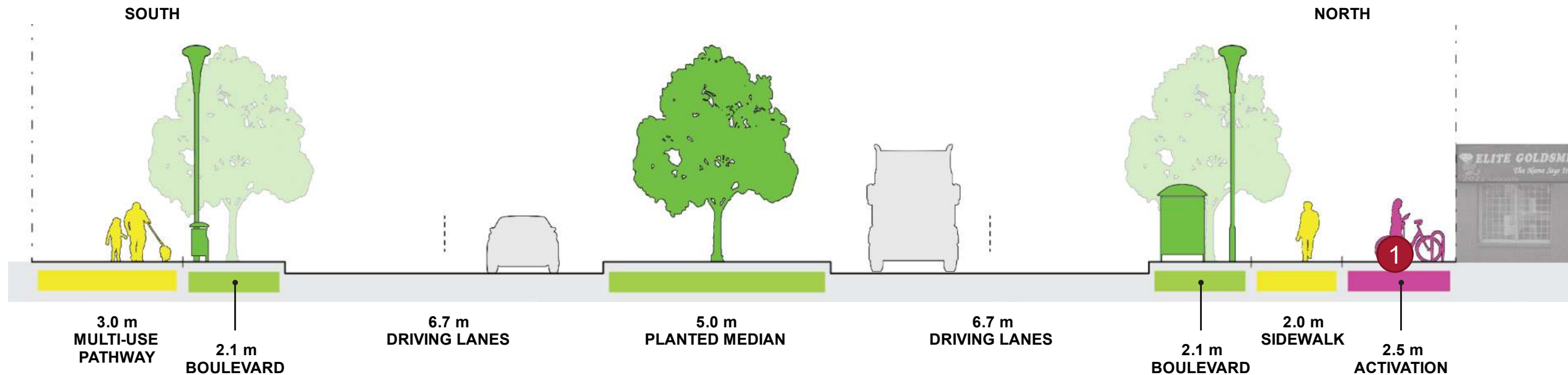

# Transportation Design – Zone 3: (Hamilton to Broad):

- 1 **Multi-use pathway** transitions to be next to the road due to utility conflicts on the south side.
- 2 No **Activation Area** as Dewdney Ave needs to realign at Broad Street

SOUTH

NORTH

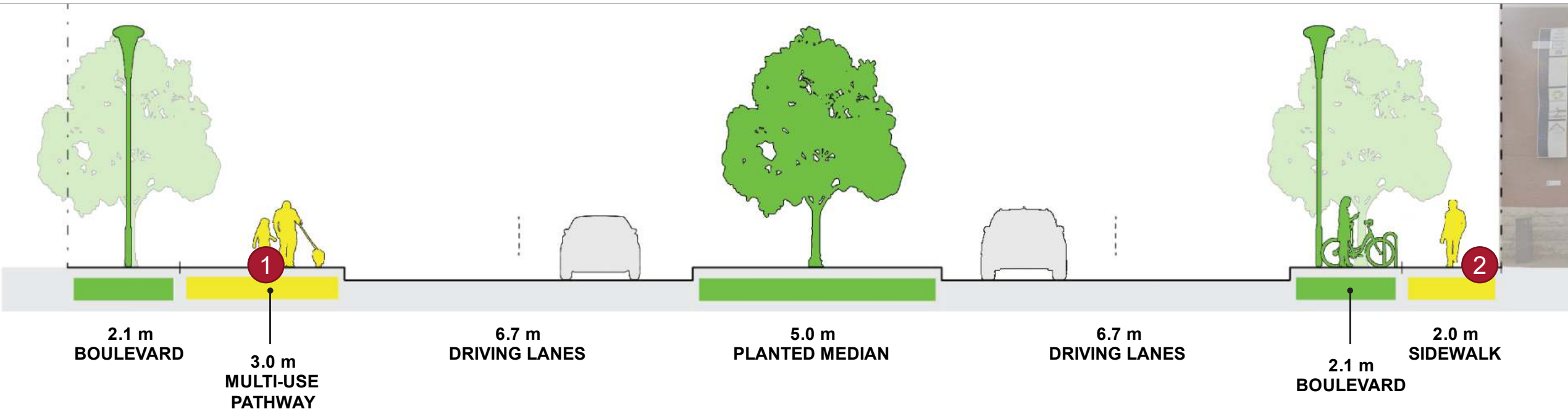

# Transportation Design – Intersections

## Signalized Intersections Features:

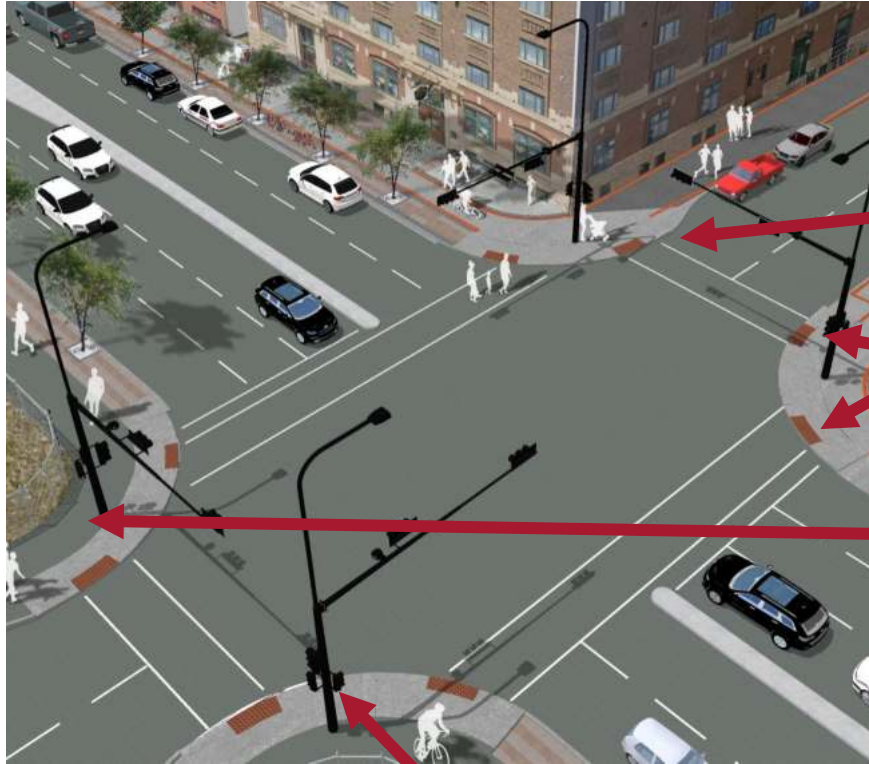

**Audible Pedestrian Signals** to support safe crossings for the hearing impaired.

## All Intersections Features:

**Bulb-outs** on N/S Streets providing improved pedestrian safety.

**Double Pedestrian Ramps** and **Crosswalks** at 90 degrees to support safe crossings for the visually impaired.

**Landing Zone** behind pedestrian ramps to support cyclist and higher volumes of pedestrians.

## Non - Signalized Intersections Features:

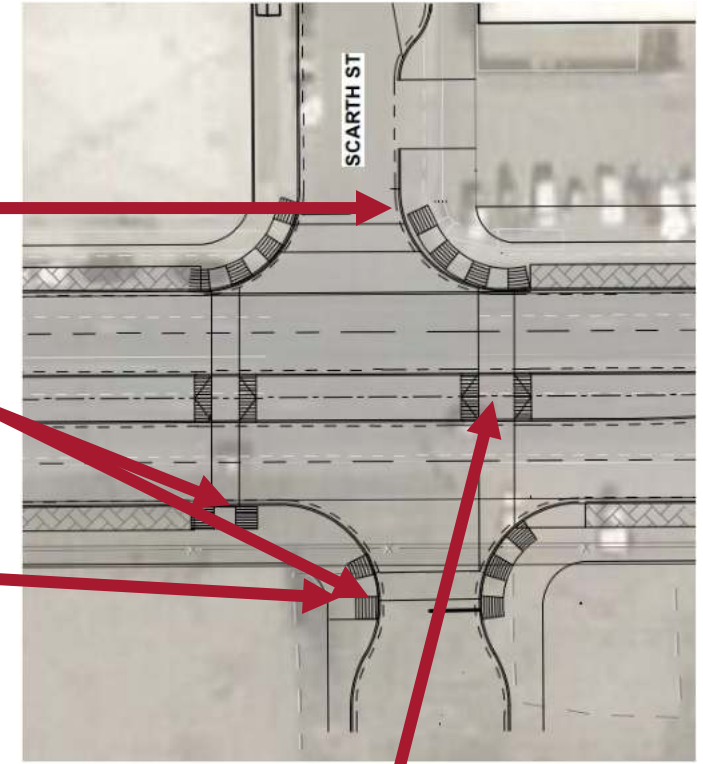





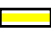

**Pedestrian Refuge** in the medians to allow for 2-stage crossings.

# Multi-Modal Mobility

Includes walking, biking,  
transit and vehicles

**LEGEND**

-  Sidewalks
-  Temporary Multi-use Pathway
-  Shared Bike / Bus Lane
-  Future Cycling Route
-  Potential Pedestrian Bridge
-  Transit Routes
-  Transit Stops

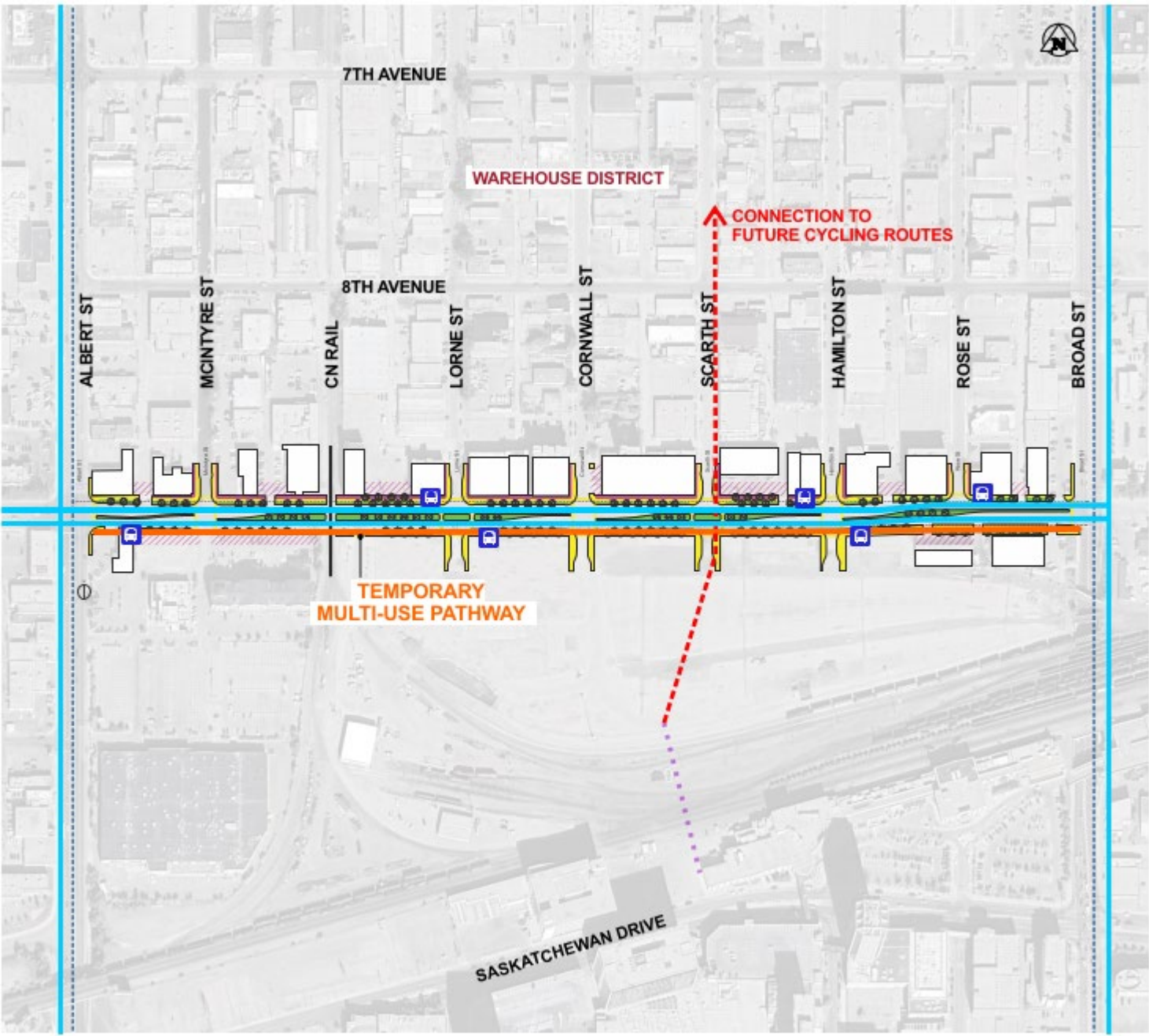

# Streetscape Design

## What we heard:

- Provide **Branded / Custom** furniture.
- Incorporate **Public Art & Murals**.
- Improve **street lighting** for pedestrian safety.
- Develop an **urban tree canopy**.



# Streetscape Design – Tree Plantings

## Silva Cells – In Boulevards



## Median Section

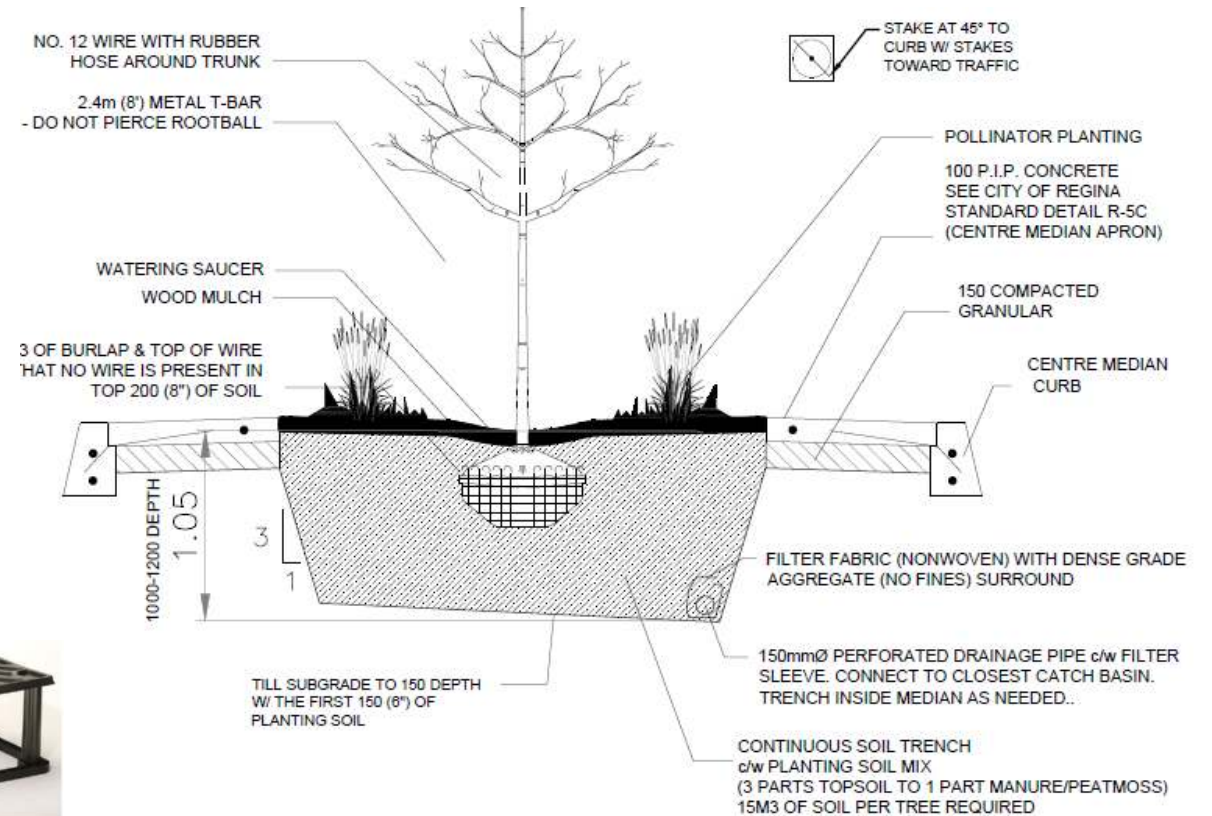

# Streetscape Design – Tree Types



American  
Elm



Brandon  
Elm



Discovery  
Elm



Dropmore  
Linden



Mountain  
Ash



Tree Lilac



Ornamental  
Crab

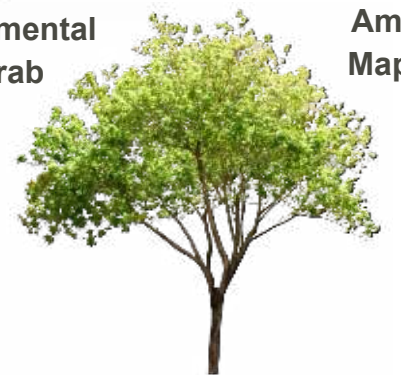

Pincherry



Amur  
Maple

# Streetscape Design - Site Details

## Pavers



Antique Brown



Charcoal

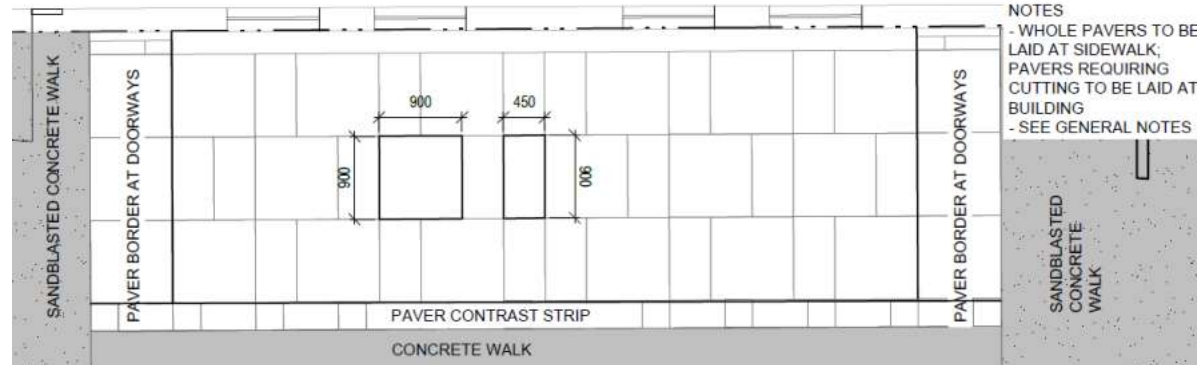

## Tree Grate

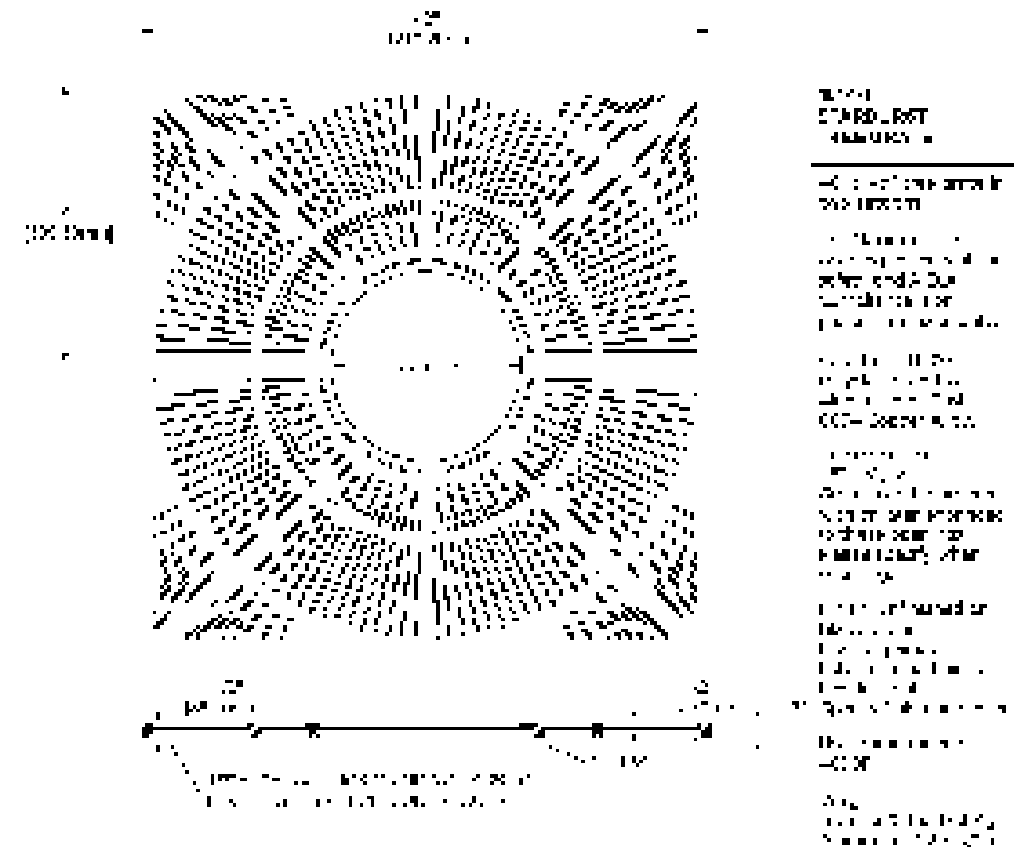

# Streetscape Design - Site Details

Bench



Planters



Bike Rack



Recycle/Trash Unit





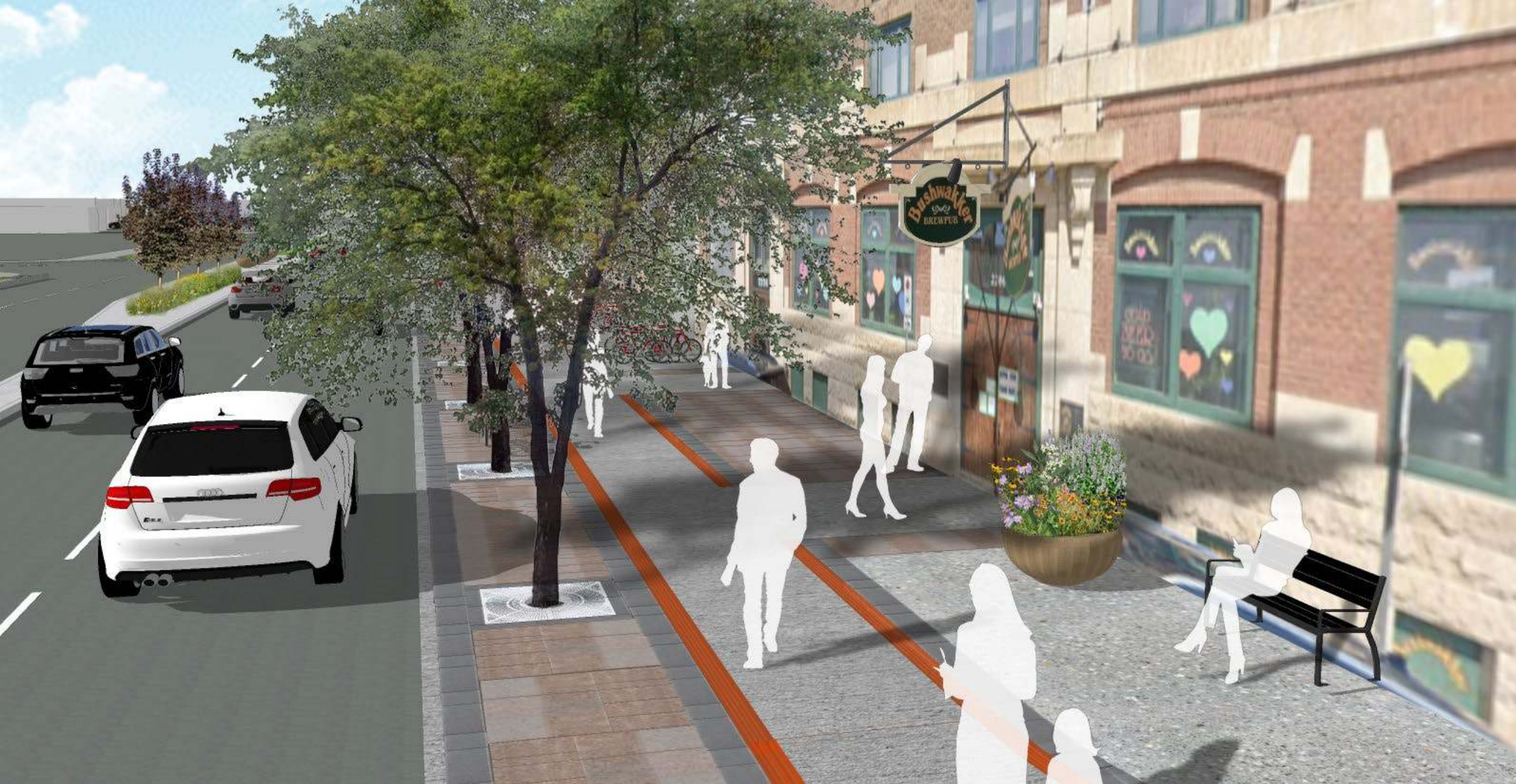



# Construction - 2023 (Preliminary Phase 1)

## Phase 1A - South Side Underground Works

### *Planned Work:*

- Install new water supply main.
- Set up servicing to future Yards site.
- Install new catch basins.

***Tentative Schedule:*** June – August 2023

### *Phase Impacts:*

- No expected water and sewer disruptions.
- Traffic restrictions with one lane in each direction maintained on north side.
- No expected business access disruptions.

## Phase 1B - North Side Underground Works

### *Planned Work:*

- Water – install hydrants and upsized watermain.
- Wastewater – install new storage element and sewer main.
- Stormwater – install catch basins and new storm sewer.

***Tentative Schedule:*** August – November 2023

### *Phase Impacts:*

- Short duration (~ 1 day) water and sewer disruptions are expected during this phase.
- Traffic restrictions in place with one lane in each direction maintained on south side.
- No expected business access disruptions.



# Construction - 2024 (Preliminary Phase 2)

## Phase 2A – North Side Surface Works

### *Planned Work:*

- Remove and replace existing road structure.
- Construction of soil cells, boulevards, sidewalk, and activation areas.
- Construction of the north half of median.

***Tentative Schedule:*** June – August 2024

### *Phase Impacts:*

- No expected water and sewer disruptions.
- Traffic restrictions in place with one lane in each direction maintained on south side.
- Temporary business access disruptions (2-4 weeks).

## Phase 2B – South Side Surface Works

### *Planned Work:*

- Remove and replace existing road structure.
- Construction of soil cells, boulevard, and pathway.
- South half of median.

***Tentative Schedule:*** August – November 2024

### *Phase Impacts:*

- No expected water and sewer disruptions.
- Traffic restrictions in place with one lane in each direction maintained on south side.
- No expected business access disruptions.



# Construction - Preliminary *Special Restrictions* Phase

## Special Restrictions – Railway Crossing/Key Intersections

### *Planned Work:*

- Underground work at key intersections or railway crossing.
- Surface Improvements at key intersections or railway crossing.

*Tentative Schedule:* TBD

### *Anticipated Impacts:*

- No expected water and sewer disruptions.
- Temporary traffic restrictions or short duration full-road closures (TBD).
- No expected business access disruptions.

## Legend



**Special Restriction  
Construction**



# Construction - Impacts



## Vehicle Traffic

- Traffic restricted to one lane each direction.
- Up to three (3) intersection traffic restrictions:
  - *One (1) fully closed intersection.*
  - *Two (2) intersections with traffic restrictions.*
- Short duration road closures.



## Pedestrian

- Temporary sidewalk closures.
- Designated pedestrian crossings for Yards temporary parking.



## Transit

- Transit continues during construction.
- Temporary detours to 8th Avenue may be required.



## Parking

- 120 temporary parking stalls provided on the Yards site during construction.

# Construction - Impacts



## Safety

- Construction fencing will be used to separate the active construction site from the public.



## Noise

- Construction will be limited to 7:00 am to 10:00 p.m.



## Business Access

- Business access maintained during construction.
- Rerouting through side/back entrance (if required).



## Communication

- Frequent Progress Updates.
- Point person at the City to contact regarding concerns.
- Construction Communication Plan.

# Construction - Communications

## General Public

- Billboards, radio ads, news releases
- Social Media posts
- Regina Road Report
- Regina Transit Live
- Project Webpage ([Regina.ca/DewdneyCorridor](http://Regina.ca/DewdneyCorridor))
- Service Regina (777-7000)
- [DewdneyCorridor@Regina.ca](mailto:DewdneyCorridor@Regina.ca)
- Advance warning signs

## RWBID/Warehouse District

- Letter notification for start of construction and prior to major phase changes
- Bi-weekly updates via email shared with RWBID

## Resident/Businesses Along Dewdney Avenue

- Letter drop-offs in advance of water or sewer service disruptions (1-2 weeks notice)
- Letters drop-offs in advance of access disruptions (1-2 weeks notice)
- In-person meetings with residents/businesses (as-needed)



# Questions?

**Contact: [DewdneyCorridor@Regina.ca](mailto:DewdneyCorridor@Regina.ca)**



Regina.ca

