

Information Sheet

DISCRETIONARY USE (PL202100040)
1730 Cowan Crescent
Institution, Daycare

1730 Cowan Crescent

Overview

Background	<ul style="list-style-type: none"> The subject property is located within the Hillsdale neighbourhood. The site is currently a residential property and is proposed to be converted to a daycare. The property is zoned R1 – Residential Detached Zone.
Proposal	<ul style="list-style-type: none"> The applicant proposes to operate a daycare for 30 school-aged children. The applicant operates a daycare at the nearby elementary school, Ecole Monseigneur De Laval and next door at 2 Turgeon Crescent. Institution, Daycare is a discretionary use when there are more than 12 children. The application is consistent with <i>The Regina Zoning Bylaw 2019</i> including the total parking requirement for the development.

Additional Information

Process	<ul style="list-style-type: none"> Refer to the Application Review Process on back of page. Any person is free to address Regina Planning Commission or City Council. If you wish to be kept informed about the date and time of these meetings, be sure to give the City your contact information. The application will require approval by City Council.
Regina Planning Commission / City Council Meeting	Visit www.Regina.ca/proposeddevelopment for updates on this application.
Contact	Michael Sliva, City Planner II Planning and Development Services Department proposeddevelopment@regina.ca / 306-777-7000



Opportunities for Public Input

- Learn about proposed development
- Attend Open House (If applicable)
- Provide feedback

Appear at Planning Commission

Appear at City Council

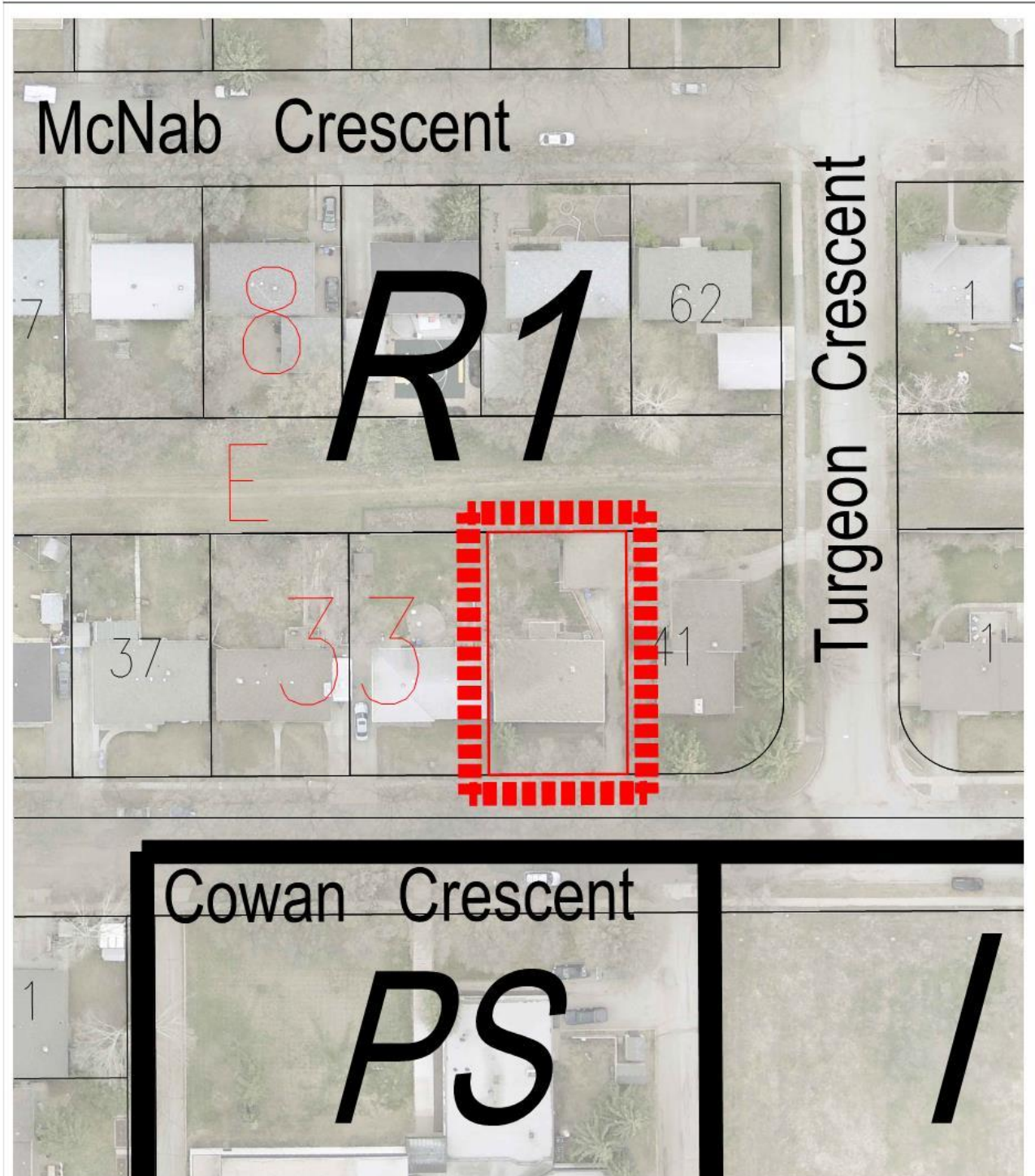

 Subject Property

Date of Photography : 2018



Project PL202100040 Civic Address/Subdivision 1730 Cowan Crescent



Subject Property

Date of Photography: 2018

