

## Information Sheet

ZONING BYLAW AMENDMENT & SALE OF DEDICATED LAND  
(PL202100081)  
3043 E Arens Road

### 3043 E Arens Road

#### Overview

##### Background

- The subject property is located within the Wood Meadows neighbourhood.
- City Council has agreed in principle to transfer a 1.353 hectare portion of open space at Ready Park from the City of Regina to the Regina Board of Education (RBE) to satisfy a outstanding 1987 agreement.

##### Proposal

- The City of Regina Real Estate Branch proposes to transfer a portion of the Ready Park at 3043 E Arens Road to RBE.
- The property is proposed to be rezoned from PS – Public Service zone to I – Institution zone.
- **There are no anticipated changes to the land use.** A joint use agreement between the City and RBE would allow continued public access and programming on the W.F. Ready School site.

#### Additional Information

##### Process

- Refer to the Application Review Process on back of page.
- Any person is free to address Regina Planning Commission or City Council. If you wish to be kept informed about the date and time of these meetings, be sure to give the City your contact information.
- The application will require approval by City Council.

##### Regina Planning Commission / City Council Meeting

Visit [www.Regina.ca/proposeddevelopment](http://www.Regina.ca/proposeddevelopment) for updates on this application

##### Contact

Michael Sliva, City Planner II  
Planning and Development Services Department  
[proposeddevelopment@regina.ca](mailto:proposeddevelopment@regina.ca) / 306-777-7000



## Opportunities for Public Input

- Learn about proposed development
  - Further public consultation (If applicable)
  - Provide feedback
- Appear at Planning Commission
- Appear at City Council

### Appendix A-1

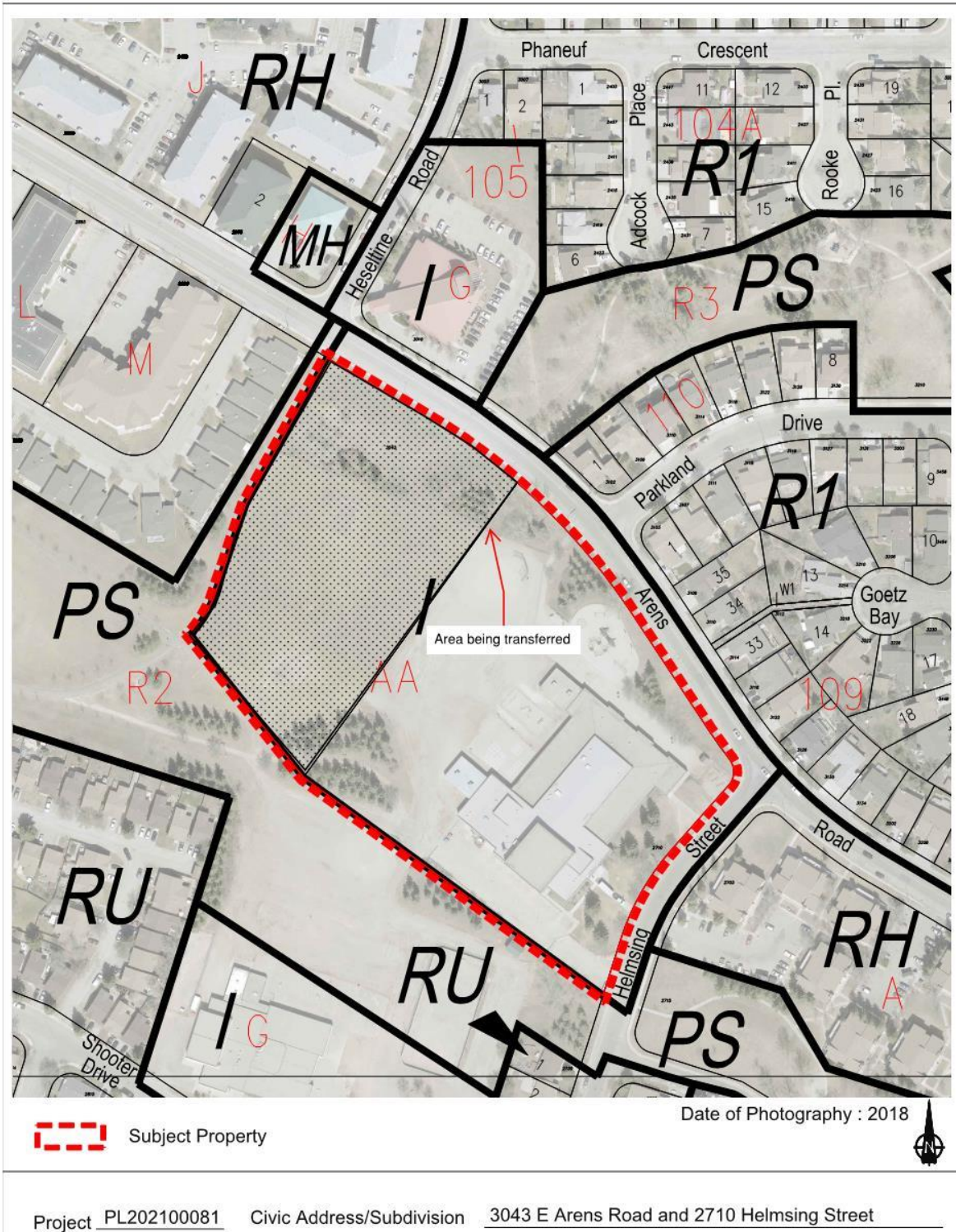

# Appendix A-2



 Subject Property

Date of Photography: 2018



Project PL202100081 Civic Address/Subdivision 3043 E Arens Road and 2710 Helmsing Street

Planning & Development Services Department  
City Planning & Community Development Division  
Queen Elizabeth II Court | 2476 Victoria Avenue  
PO Box 1790 | REGINA SK S4P 3C8  
P:306-777-7000 | F:306-777-6823